

INSTALLATION MANUAL

No Touch Exit Sensor PTE-300



Features & Application:

- No touch / Touchfree Exit Sensor(Diffused Detection)
- Optical / Infrared Technology
- IP-55 Ingress Protection/ SUS 304 Stainless steel Plate
- User friendly (Healthyprotection):
Free from contagious diseases spread
- Detection range: 0.1~ 10 cm
- Application: Gate/Door/Exit/Automation control
- High capacity of relay dry contact(3A/AC120V,DC30V)
Normally open/Normally close/Common relay output
- Twin led indicators for sensor standby or approached:
(1) Sensor Standby:**BLUE LED ON**
(2) Visitors whom approached to the sensor in 10 cm:
RED LED ON

Included:

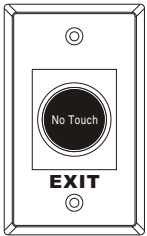

PTE-300



SCREWS

Specifications:

- Contact Rating: 3A/AC120V,DC30V
- Input Volt.:DC 12V
- Simple and clear for operation.
- Operation temperature range -20°C ~55°C
- Life: 100,000 Times
- Durable stainless steel plate
- Dimension: 115x70x29(mm)
- Weight: 85g

Dimensions & Part Account:

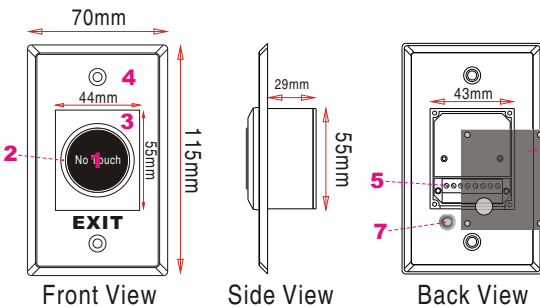

1. Lens: Black finish
2. Round Shape Led Indicators
3. Lens Holder: Silver finish
(Same finish as Metal Plate)
4. Metal Plate: Silver finish
(SUS 304 stainless material)
5. Terminal Block:
PTE-300: 5 blocks (1c relay)
6. Lids: Bottom casing for diffused sensor
7. Rubber ring for wiring connection

Wiring Connection:

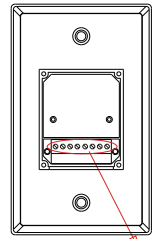
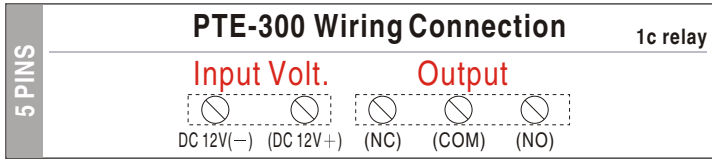

Terminal block

Installation:

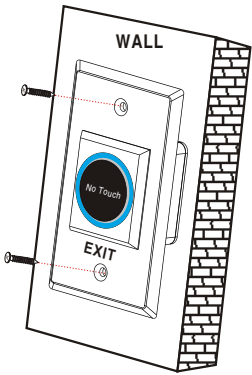

Sensing Range:

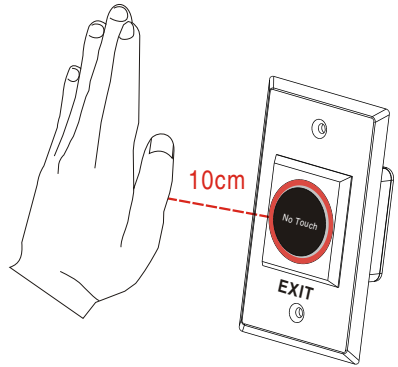

LED Indicator:

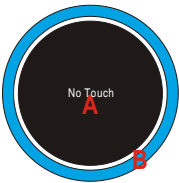

A: Black / PC Lens
B: Round Shape LED Indicator

